

CULVERT CLOSURE DETOUR (STAGE 2)

See sign fabrication sheets for design of signs paid for by "Sign, Type B, Temp, Special."

See sign fabrication sheets for design of signs paid for by "Sign, Type B, Temp, Special."

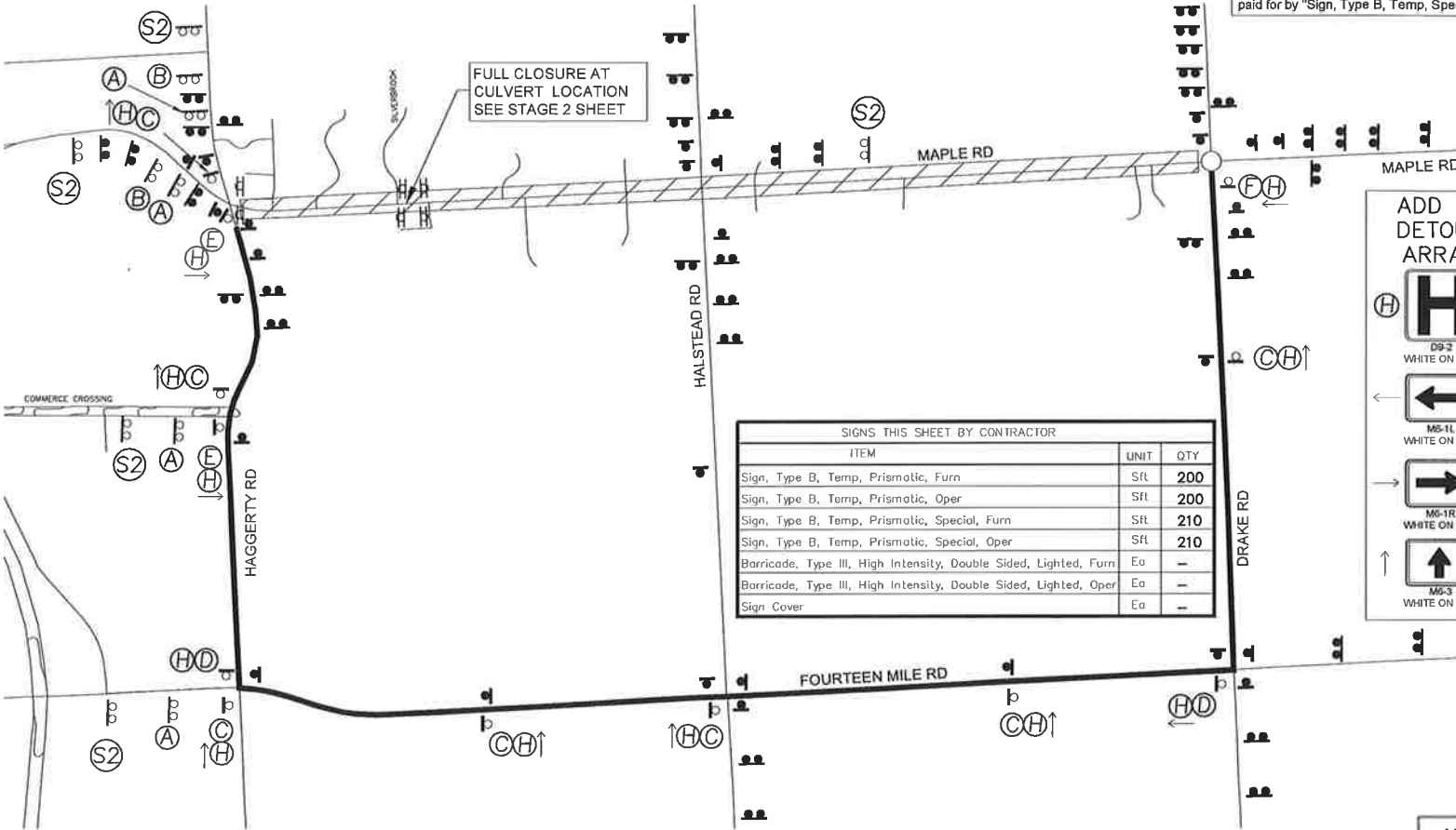

FULL CLOSURE AT
CULVERT LOCATION
SEE STAGE 2 SHEET

SIGNS THIS SHEET BY CONTRACTOR		
ITEM	UNIT	QTY
Sign, Type B, Temp, Prismatic, Furn	Sft	200
Sign, Type B, Temp, Prismatic, Oper	Sft	200
Sign, Type B, Temp, Prismatic, Special, Furn	Sft	210
Sign, Type B, Temp, Prismatic, Special, Oper	Sft	210
Barricade, Type III, High Intensity, Double Sided, Lighted, Furn	Ea	-
Barricade, Type III, High Intensity, Double Sided, Lighted, Oper	Ea	-
Sign Cover	Ea	-

ADD TO
DETOUR
ARRAY

- H D3-3 WHITE ON BLUE
- ← M5-1L WHITE ON BLUE
- M6-1R WHITE ON BLUE
- ↑ M6-3 WHITE ON BLUE

- A W20-2-48 Maple Rd Const D3-2
- B W20-3-48 Maple Rd Const D3-2
- C D3-1 Detour Maple Rd M4-9-30
- D D3-1 Detour Maple Rd M4-9-30
- E D3-1 Detour Maple Rd M4-9-30
- F D3-1 Detour Maple Rd M4-6A-34

- SIGNS REQUIRED FOR THIS SHEET
- 11 - M4-9 (24x18)
 - 1 - M4-9a (24x18)
 - 4 - W20-2 (48x48)
 - 2 - W20-3 (48x48)
 - 12 - D3-1 DETOUR (30x12)
 - 6 - D3-2 CONST (48x18)
 - 5 - SPECIAL S2 (96x48)
 - 12 - D9-2 HOSPITAL (16x18)
 - 12 - M6 ARROW (21x15)

Construction Detour for west bound
Maple Rd to remain in place.

Maple Rd Closed
East of Haggerty Rd
Follow Detour
Starting XX/XX/XX

UNCLERIFIED - MAPLE ROAD HAGGERTY TO DRAKE ROAD PERMITTER'S UNCLERIFIED SAFETY/WEAR. SEE DETOUR SIGNING MAP 18, 19, 20, 21 AM

PROJECT NAME: MAPLE ROAD, HAGGERTY ROAD TO DRAKE ROAD
CONTRACT SECTION: M001-1409-00
DATE: 11/27/14
ENGINEER: SQUAD 2